

REDUCTOR PRESIUNE CU FILTRU SI LUBRIFICATOR PENTRU AER COMPRIMAT *H&E*C

CARACTERISTICI TEHNICE:

- ⊗ material corp: aluminiu
- ⊗ material vas: polycarbonate
- ⊗ finețe filtru: 25 microni [opțional 5μm]
- ⊗ ulei: ISOVG32
- ⊗ presiunea maxima de lucru: 10 bar
- ⊗ presiunea de reglare: 0,5 - 8.5 bar
- ⊗ temperatura de lucru maxima: +5°C / +60°C
- ⊗ livrare cu manometru si suport prindere
- ⊗ conexiune filet interior



MATERIALE:

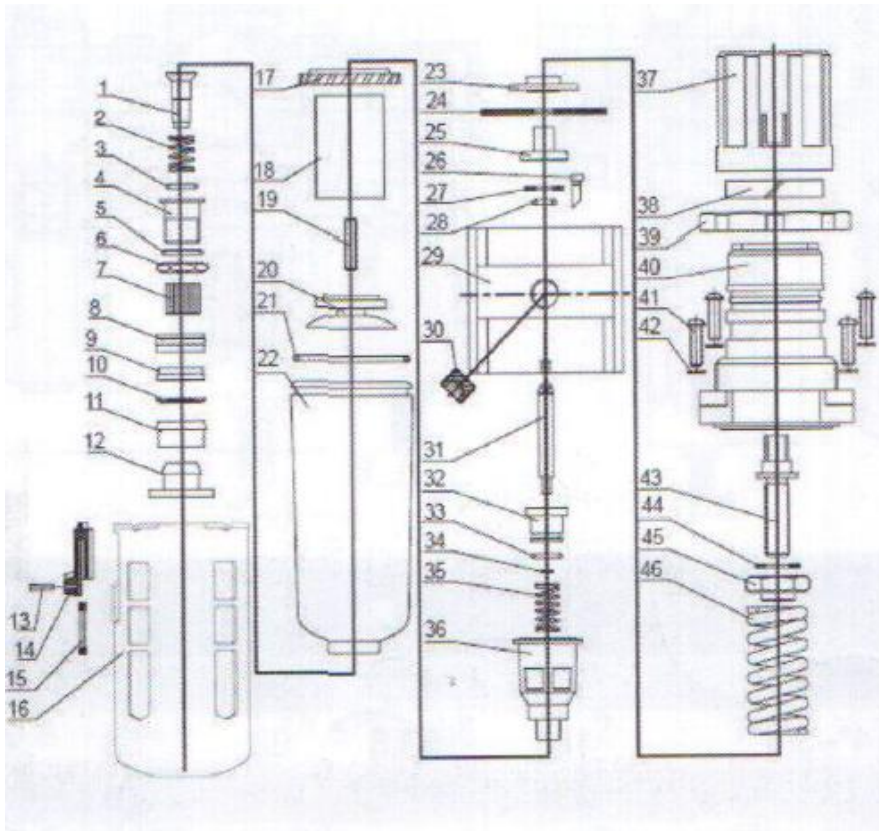

46	Arc	Otel carbon
45	Pilutita	Otel carbon
44	Șaiba	POM
43	Șurub	Otel carbon
42	Arc șaiba	Otel carbon
41	Șurub	Otel carbon
40	Cap regulator	Nylon ranforsat
39	Piulița	Nylon ranforsat
38	Inel	Nylon ranforsat
37	Mâner regulator	Nylon ranforsat
36	Scaun deversor	ZZnAl4-1
35	Arc	Otel inox
34	Inel	Otel carbon
33	O-ring	NBR
32	Miez	Alama
31	Țeava	Alama + NBR
30	Plug	Otel carbon
29	Corp regulator	Aluminiu
28	O-ring	NBR
27	Inel	Otel carbon
26	Țeava	POM
25	Scaun diafragma	Alama
24	Diafragma	NBR
23	Diafragma	Otel carbon
22	Vas	Polycarbonate
21	O-ring	NBR
20	Drener	ABS
19	Șurub	Otel carbon
18	Element filtru	Alama
17	Lame	ABS
16	Protecție vas	Otel carbon
15	Arc	Inox
14	Blocaj	ABS

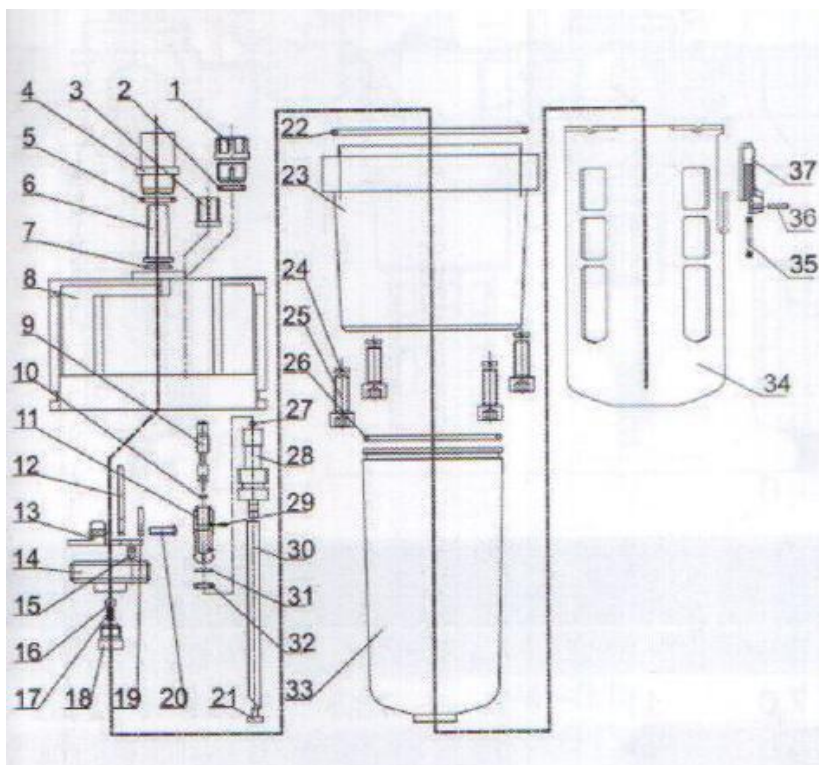

13	Cep	ABS
12	Buton	POM
11	Bucșa	POM
10	Inel	Inox
9	Inel	POM
8	O-ring	NBR
7	Piulița	Alama
6	Pilulita HEX	Alama
5	O-ring	NBR
4	Drener	Alama
3	O-ring	NBR
2	Arc	Inox
1	Miez	Alama
37	Blocaj	ABS
36	Cep	ABS
35	Arc	Inox
34	Protecție vas	Otel carbon
33	Vas ulei	Polycarbonate
32	O-ring	NBR
31	O-ring	NBR
30	Tub ulei	PU
29	Cep	Otel carbon
28	Fiting	POM
27	Bila	Otel carbon
26	O-ring	NBR
25	Șurub HEX	Otel carbon
24	Arc șaiba	Otel carbon
23	Partea mijlocie	Aluminium
22	O-ring	NBR
21	Element filtru	Alama
20	Șurub	Otel carbon
19	Scaun tija	ZZnAl4-1
18	Scaun	Alama
17	Arc	Inox
16	Bila	Otel carbon
15	Gaura scaun	Alama
14	Suport	ZZnAl4-1
13	Scaun tija	ZZnAl4-1
12	Tija	Poliuretan
11	Scaun lubrifiant	Alama
10	O-ring	NBR
9	Ac	Alama
8	Corp lubrifiant	Aluminium
7	O-ring	NBR
6	Tub ulei	Polycarbonate
5	O-ring	NBR
4	Tub ulei	Polycarbonate
3	Șurub ulei	ABS
2	O-ring	NBR
1	Plug	ABS

MODEL	DEBIT [L/MIN]	DN	DN RACORD MANOMETRU	GREUTATE	SUPORT
HEC2010-01	500	1/8"	1/8"	0.66	Y20T
HEC2010-02		1/4"			
HEC3010-02	1700	1/4"	1/8"	0.98	T30T
HEC3010-03		3/8"			
HEC4010-03	3000	3/8"	1/4"	1.93	Y40T
HEC4010-04		1/2"			
HEC4010-06	3000	3/4"	1/4"	1.99	Y50T
HEC5010-06	4000	3/4"	1/4"	3.20	Y60T
HEC5010-10		1"			

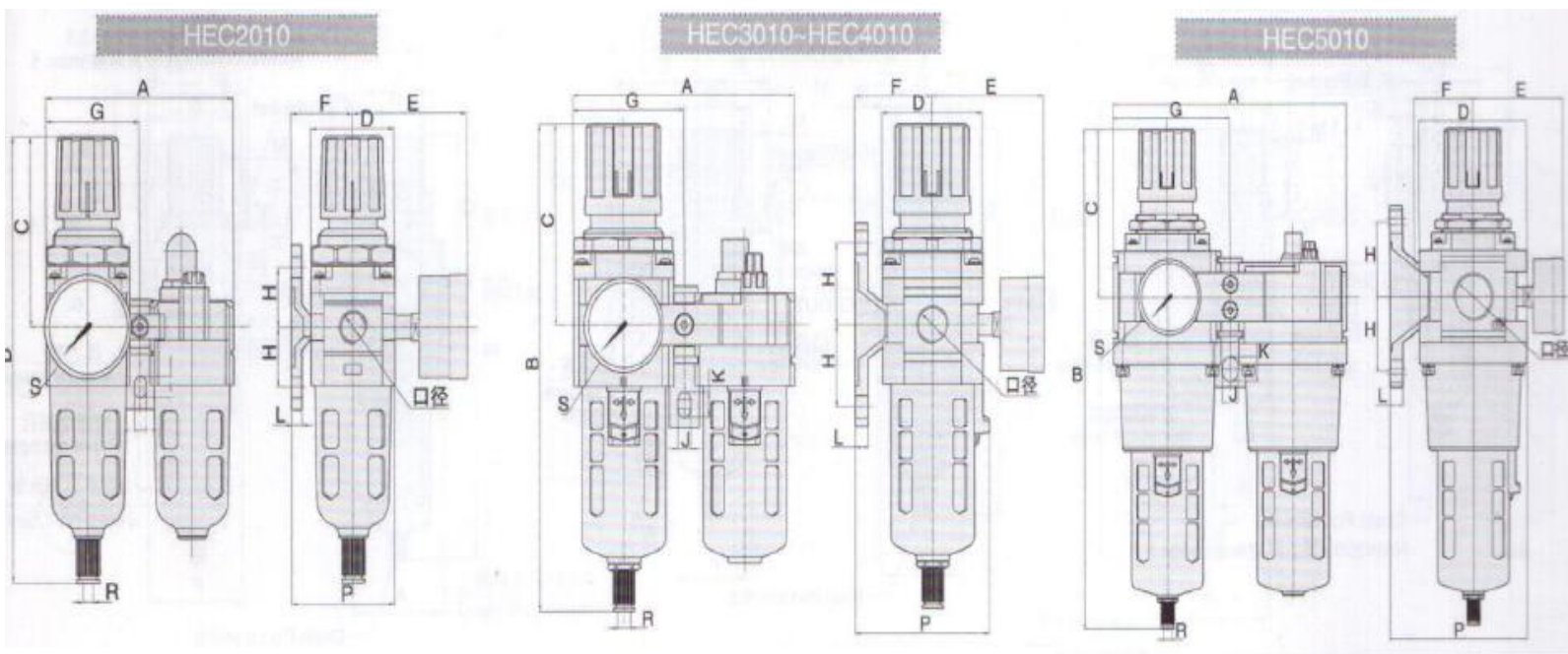

MODEL	DN	A	B	C	D	E	F	G	H	J	K	L	P	R	S
HEC2010	1/8-1/4"	90	180	78	40	56.8	30	45	24	5.5	8.5	5	50	Ø6	G1/8
HEC3010	1/4-3/8"	117	218	92.5	53	60.8	41	58.5	35	7	11	7	70.5	Ø8	G1/8
HEC4010-04	3/8-1/2"	154	269	112	70	65.5	50	77	40	9	13	7	88	Ø8	G1/4
HEC4010-06	3/4"	164	274	114	70	69.5	50	82	40	9	13	7	88	Ø8	G1/4
HEC5010	3/4"-1"	195	345	116	90	75.5	69.8	97.5	50	12	16	10.5	115	Ø8	G1/4