

## REDUCTOR PRESIUNE AER COMPRIMAT ER

### CARACTERISTICI TEHNICE:

- ∞ material corp: aluminiu
- ∞ presiunea maxima de lucru: 10 bar
- ∞ presiunea de reglare: 0,5 - 8.5 bar
- ∞ temperatura de lucru maxima: +5°C / +60°C
- ∞ livrare cu manometru si suport prindere
- ∞ conexiune filet interior



### MATERIALE:

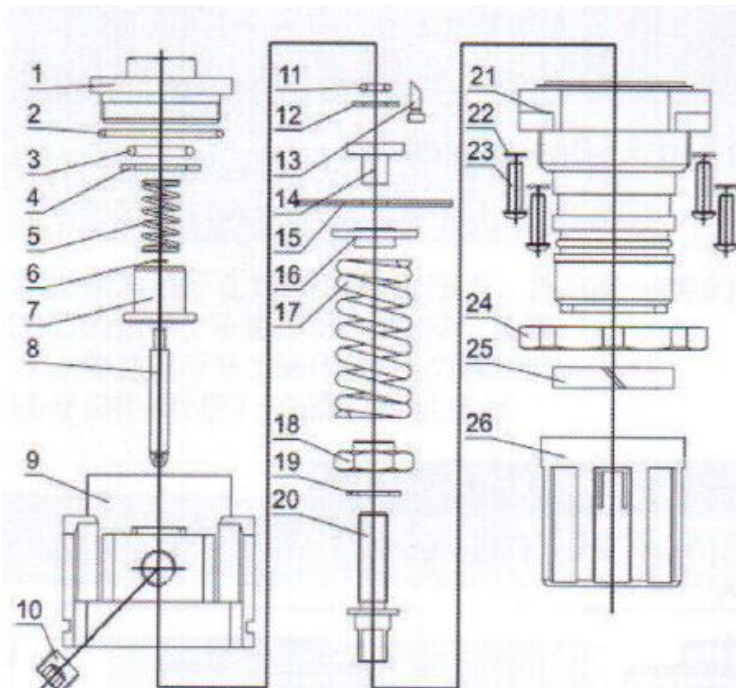

26	Mâner reglare	Nylon ranforsat
25	Inel	Nylon ranforsat
24	Piulița	Nylon ranforsat
23	Șurub	Otel carbon
22	Arc șaiba	Otel carbon
21	Cap reductor	Nylon ranforsat
20	Șurub reductor	Otel carbon
19	Șaiba	POM
18	Piulița reductor	Otel carbon
17	Arc	Otel carbon
16	Scaun arc	Otel carbon
15	Diafragma	NBR
14	Scaun diafragma	Alama
13	Țeava	POM
12	Inel reținere	Otel carbon
11	Garnitura	NBR
10	Plug	Otel carbon
9	Corp reductor	Aluminiu
8	Tub	NBR Alama+NBR
7	Miez	Alama
6	Inel reținere	Otel carbon
5	Arc	Inox
4	Șaiba	Otel carbon
3	Garnitura	NBR
2	Garnitura	NBR
1	Scaun reductor	ZZn414-1

MODEL	SPECIFICATII				ACCESORII
	Debit [l/min]	DN [G]	DN racord manometru	Greutate [kg]	Suport
ER1000-M5	100	M5	1/16"	0.08	B120
ER2000-01	550	1/8"	1/8"	0.27	B220
ER2000-02		1/4"			
ER2500-02	2000	1/4"	1/8"	0.27	B220
ER2500-03		3/8"			
ER3000-02	2500	1/4"	1/8"	0.41	B320
ER3000-03		3/8"			
ER4000-03	6000	3/8"	1/4"	0.84	B420
ER4000-04		1/2"			
ER4000-06	600	3/4"	1/4"	0.94	
ER5000-06	8000	3/4"	1/4"	1.19	
ER5000-10		1"			

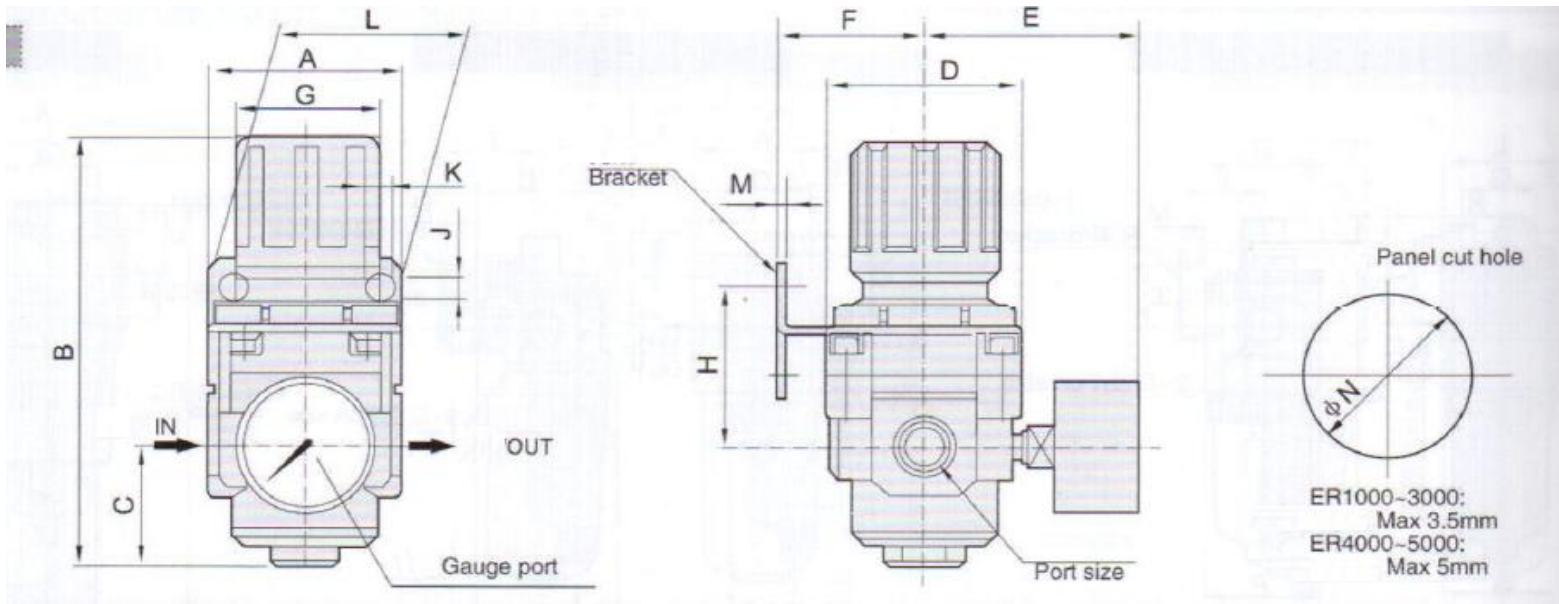
**DIMENSIUNI:**

MODEL	DN	A	B	C	D	E	F	G	H	J	K	L	M	N
ER1000	M5	25	61.5	11	25	26	25	28	30	4.5	6.5	40	2	20.5
ER2000	1/8"-1/4"	40	95	17	40	56.8	30	34	44	5.4	15.4	55	2.3	33.5
ER2500	1/4"-3/8"	53	102.5	25	48	60.8	30	34	44	5.4	15.4	55	2.3	33.5
ER3000	1/4"-3/8"	53	127.5	35	53	60.8	39	40	46	6.5	8	53	2.3	42.5
ER4000	3/8"-1/2"	70	149.5	37.5	70	65.5	49.2	54	54	8.5	10.5	70	2.3	52.5
ER4000-06	3/4"	75	154	40.5	70	69.5	49.2	54	55.5	8.5	10.5	70	2.3	52.5
ER5000	3/4"-1"	90	168	48	90	75.5	49.2	54	62	8.5	10.5	70	2.3	52.5